

# REV-A-SHELF®

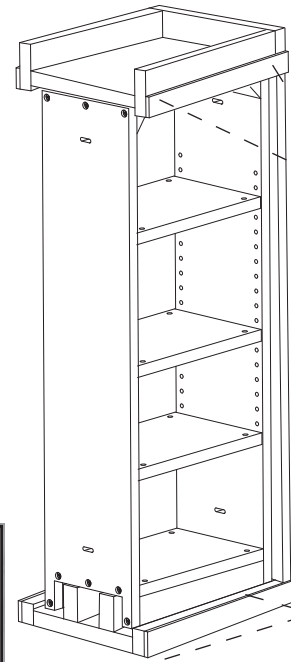

**Fig 1**

**Step 1.** Measure scribe rail thickness and length per your specific cabinetry. See Fig 1



Top Scribe Rail is nailed to bottom edge of top section

**Fig 3a  
Wall Cabinet**

Bottom Scribe Rail is nailed to edge of bottom section

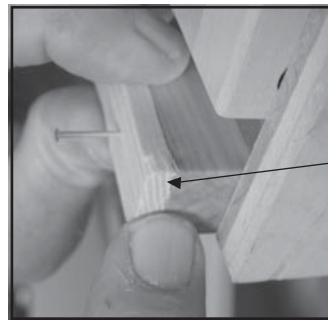

**Step 2.** Install upper and lower scribe rails to filler pull-outs using small finish nails or brads. See Fig 2. **Note:** Align scribe rails with front edge of filler pull-outs. Align scribe rail to upper section of base cabinet lower mounting strap or lower section of wall cabinet lower mounting strap. See Figs. 3a-b.

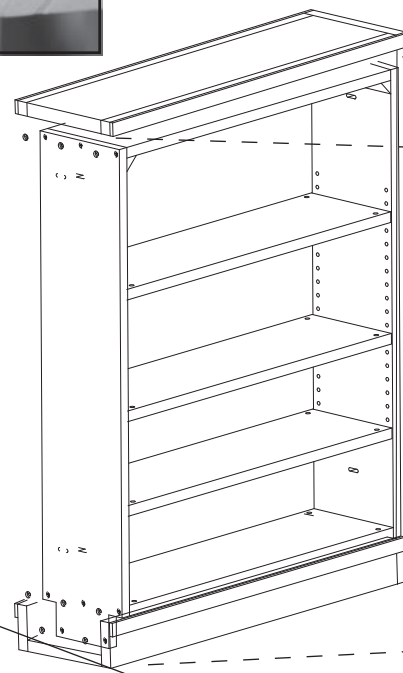

Top Scribe Rail is nailed to edge of top section

**Fig 3b  
Base Cabinet**

Bottom Scribe Rail is nailed to edge of bottom section



**Fig 2**

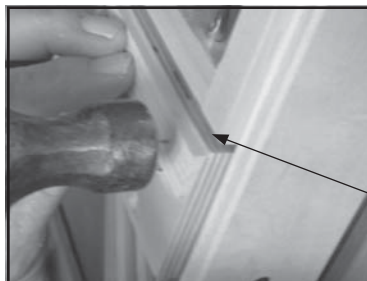



Fig 4a



Fig 4b

**Step 3. (Base Cabinets).** Pre-drill 3/16 inch holes 3/8 inch down from top of cabinet and also 27-3/4" down from top of cabinet. (See Fig 4a-d). Repeat with other adjacent cabinet.

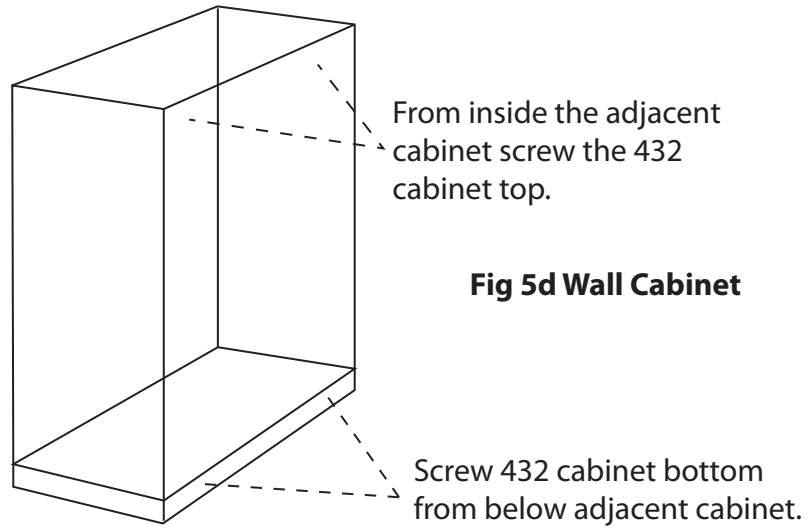

Fig 5d Wall Cabinet

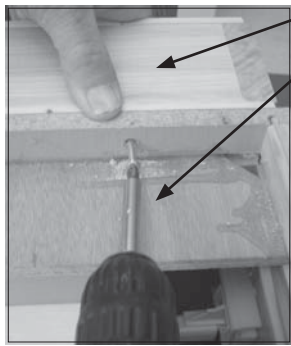

Fig 5a

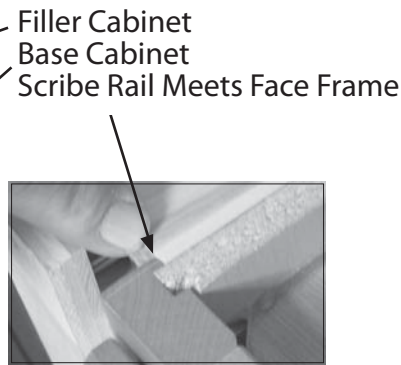

Fig 5b

**Step 4.** Mount filler cabinet pull-out to adjacent cabinet 1. See Fig. 5a-b

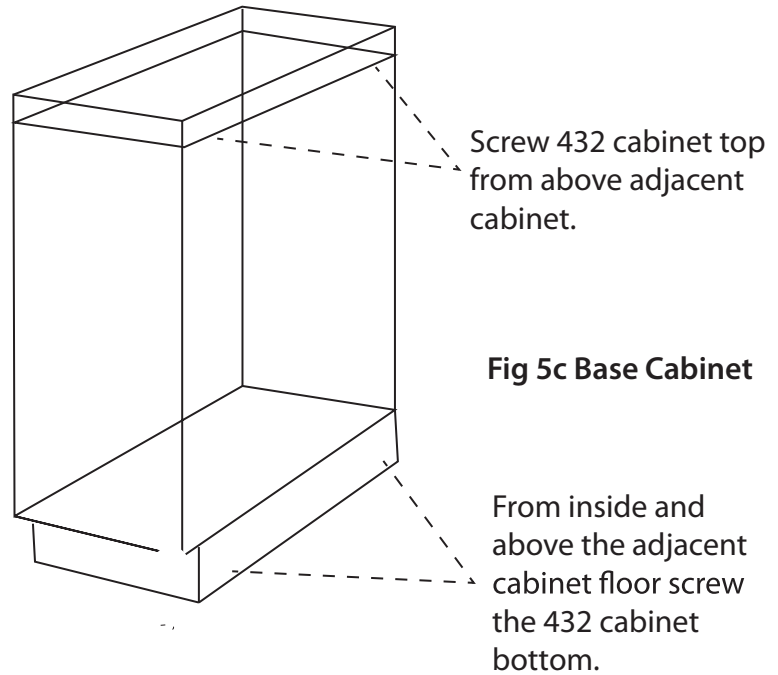

Fig 5c Base Cabinet

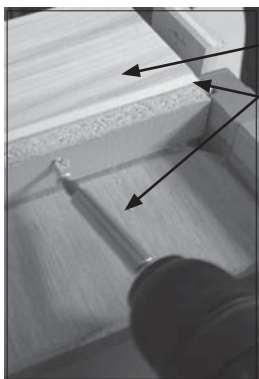

Fig 6

**Step 5.** Mount filler cabinet pull-out to adjacent cabinet 2. See Fig. 7



Fig 8

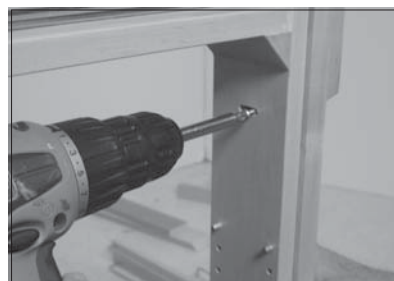

Fig 9

**Step 7.** Attach face frame and onlays (not provided) See Fig. 8-9

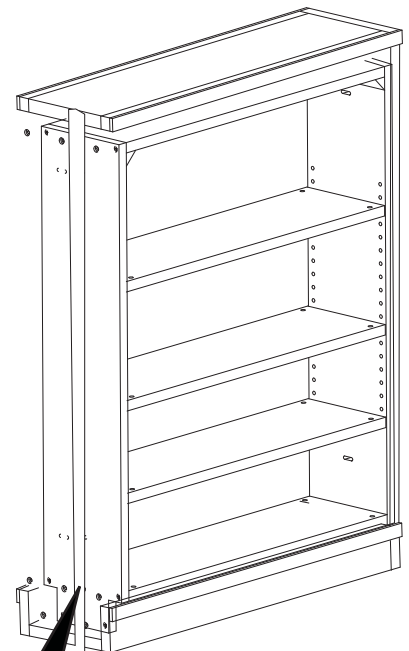

Fig 7

**Step 6.** Remove front mounting strap. See Fig 7.